

# STREETSCAPE DESIGN

## Brighton Streetscape

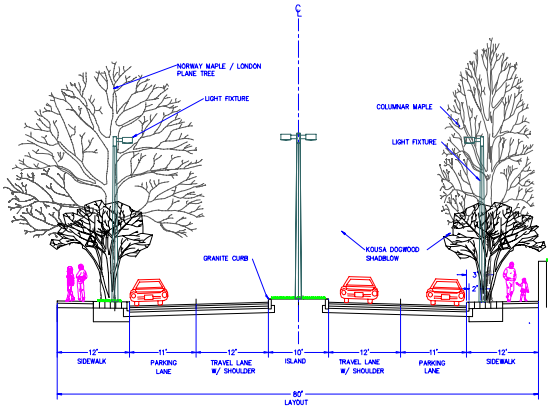

Street trees and landscaped island on Cambridge St. in Brighton.



CAMBRIDGE STREET  
FROM WASHINGTON STREET TO BARROWS STREET

Cambridge Street, Tremont Street, and Washington Street. This project involved locating street trees, designing landscaped islands, new sidewalks, special paving crosswalks, small sitting parks and lighting.

## Brighton Streetscape (Continued)



Cambridge Street street trees and tree grate.



Warren Street Island at Cambridge Street.



Oak Square and landscaped island at junction of Washington and Tremont Streets.

## Brighton Streetscape (Continued)

The Market Street Island is at the core of the Brighton business district. It is a Bus stop, a traffic diverter and a locus of specimen plantings. It was designed with the knowledge of a high level of interest in the community, therefore the use of more intense detailing (ie benches , pavement, raised planters, etc)

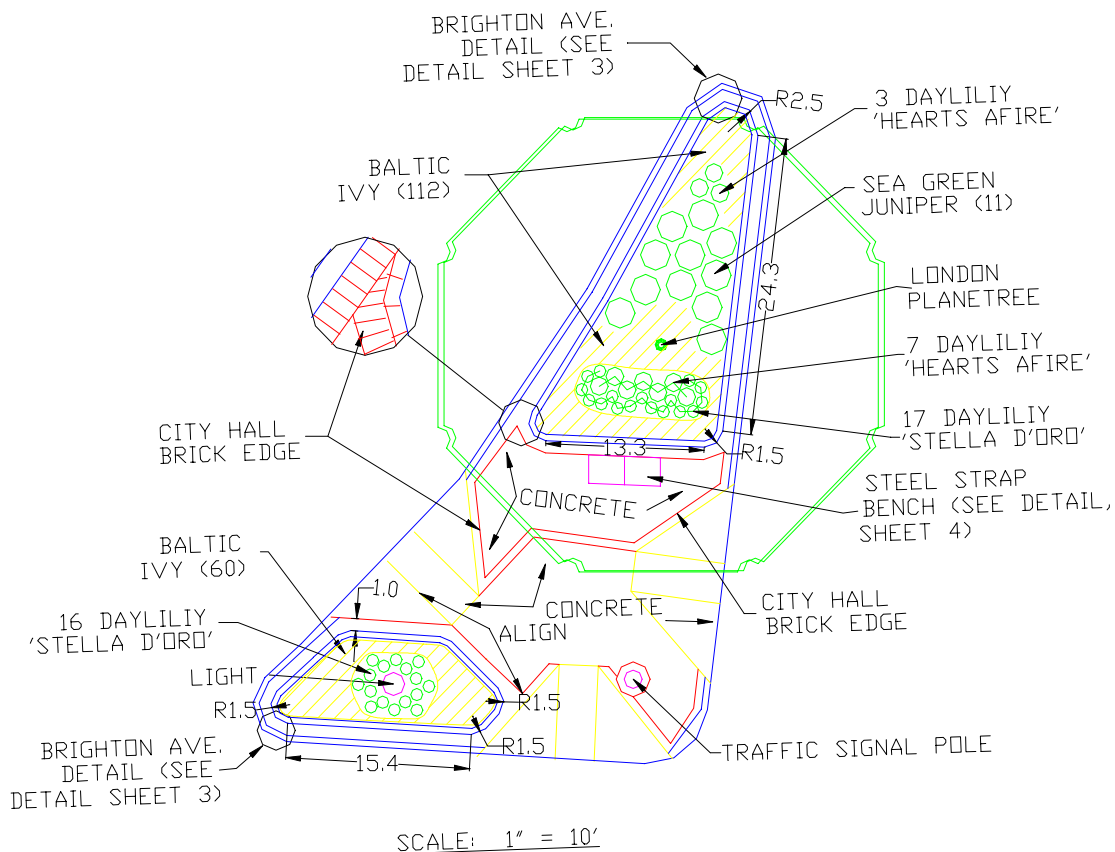

Landscaped island at the junction of Washington and Market St.