

INTRODUCTION:

Native Landscapes was formed by Robert E. Marini, Landscape Architect, with the intention of providing comprehensive *Environmental Planning and Landscape Architectural services* necessary for the issuance of local approvals and the documentation of the construction process.

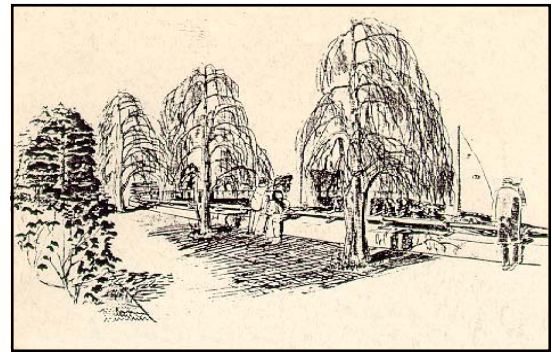

Based in Lynn, Massachusetts and Ft. Myers, Florida, Native Landscapes pursues the role of a design and environmental planning contributor nationwide. We coordinate those disciplines relevant to providing our clients with their desired results.

Being Adaptable to all geographic regions, we shall engage both public and private concerns. Always committed to the public's health, safety and welfare, we accentuate the aesthetic values of the design with the environment and history of the place to ensure that your project will endure the social and physical impacts of time.

PROJECT APPROACH:

Cluster Residential Planning:

Planning housing requires providing a sense of continuity for the whole development, while still allowing individuality for each residence. This is accomplished by incorporating open space where buffers are needed.

Park Design:

Providing open space for people to use and enjoy is important for any area. Using spatial design criteria and knowledge of, material, we create parks that will be enjoyed by all age groups,

Streetscape Design:

Using our knowledge and experience, we work with the existing city structure to improve circulation and enhance overall pedestrian and vehicular experience.

Landscape Codes:

Most new development must comply with landscape codes set by counties and other levels of government. We are well versed in addressing codes and we design aesthetically appealing landscapes that comply with the code.

Historic Restoration:

Working with local and state Historical Societies we devise plans for restoring historic structures, and provide landscapes around them that accentuate the structures. This is a site-specific process that involves cleaning materials, careful disassembly and rebuilding.

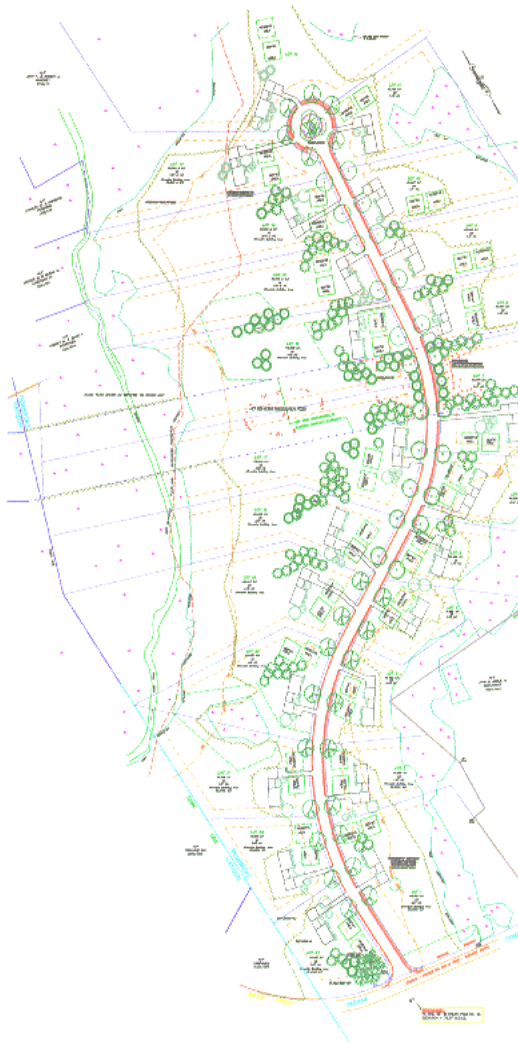

PROJECT APPROACH (continued)

Residential Design:

Whether working on a new house or improving an existing residence, we accentuate the context of the property to design a residential landscape that is not only aesthetically appealing, but functional.

Site Design:

We collaborate with other design disciplines in detailing grading and landscape plans that incorporate furnishings, lighting, irrigation, planting etc. up to the level of bid procurement.



Wetland Delineation

Using our knowledge of plant material, soils and other wetland indicators, we delineate wetlands for proposed development following the guidelines set by the DEP. This involves filling out reports including (but not limited to) Bordering Vegetated Wetlands.

Wetland Restoration

We first determine the area of affected wetlands, then impose the appropriate course of action. This generally involves a buffer between the wetlands and any adjacent hazard, removing invasive species and replacing them with native wetland plants thereby restoring the wetlands to a point where it can be enjoyed by both people and wildlife.

Wetland Replication

When permission is granted by the DEP for new development to encroach on an existing wetlands, replicated wetlands of at least the amount of area impacted must be provided. Using our knowledge and experience, we design new wetlands that perform the task of the existing wetland that was impacted, including flood water retention and wildlife habitat.



Wildlife Habitat Evaluation

This involves first determining the existing types and quantities of wildlife present and calculating the amount of habitat needed. Then that habitat is evaluated using the plant material, wetlands (where existing) and general condition of the site.